

# Jetplex Circle Business Park

## 1003 PRODUCTION COURT

### Madison, AL 35758

#### Building is 100% Occupied

- 36,300 SF
- Tilt-up Concrete Construction
- Built 2001
- Fully Sprinklered
- Fully Paved and Lighted Parking, Driveways and Courtyards
- Attractive Store Fronts
- All Offices are Built-Out to Tenant Needs
- Offices are Conditioned
- All Spaces have Handicapped Bathrooms
- 3,500 SF of Exterior Storage
- 20' Clear Ceiling Height
- Building has 11 Bays
- Bays are 30'x90' or 3,300 SF
- Each Bay has 1 Dock High Door
- Bays 100 and 700 have Drive-in Doors
- All Warehouses are Heated



Located in the Center of  
Huntsville's Growth Corridor

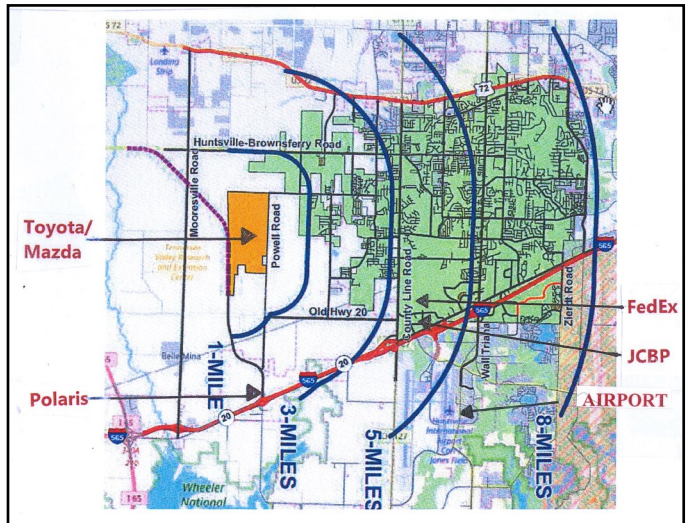

#### Convenient Location Near:

- I-565
- I-65
- Huntsville International Airport
- FedEx Air and Ground
- Toyota/Mazda & Polaris

MAL CLISSOLD  
 Office: 615-370-1770  
 Cell: 615-397-9506  
 Email: mal@jcbp.com  
 www.jcbp.com



# Jetplex Circle Business Park

## 1003 PRODUCTION COURT

### Madison, AL 35758

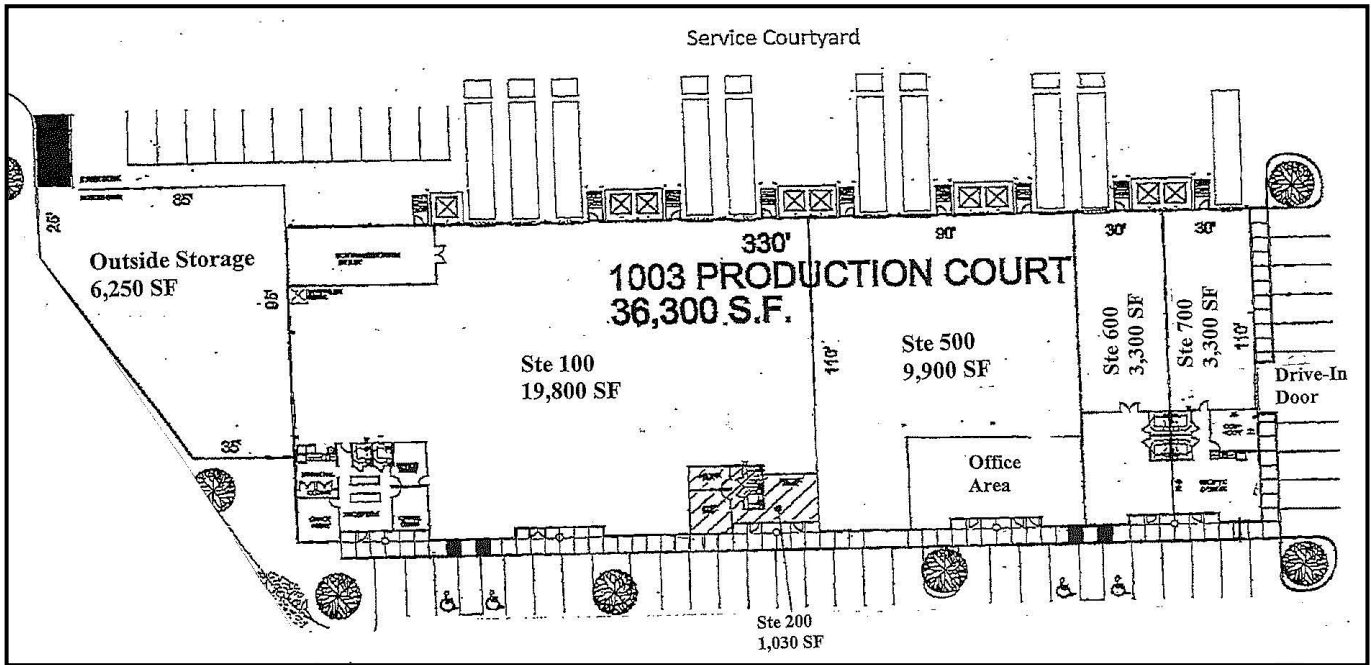

<b>Square Feet</b>				
<b>Suite</b>	<b>Total</b>	<b>Office</b>	<b>WH</b>	<b>% Office</b>
S 100	18,770	1,500	17,270	8.0%
S 200	1,030	1,030	0	100%
S 500	9,900	1,350	8,550	13.6%
S 600	3,300	1,216	2,084	36.8%
S 700	3,300	1,133	2,167	34.3%
	36,300	6,229	30,071	17.2%

MAL CLISSOLD  
 Office: 615-370-1770  
 Cell: 615-397-9506  
 Email: mal@jcbp.com  
 www.jcbp.com

**Convenient Location Near:**

- I-565
- I-65
- Huntsville International Airport
- FedEx Air and Ground
- Toyota/Mazda & Polaris

