

# Jetplex Circle Business Park

## 1021 PRODUCTION COURT

### Madison, AL 35758

### Building is 100% Occupied

- 33,000 SF
- Tilt-up Concrete Construction
- Built 2006
- Fully Sprinklered
- Fully Paved and Lighted Parking, Driveways and Courtyards
- 100% of the Space is Climate Controlled
- All Offices are Built-Out to Tenant Needs
- One Tenant Occupies Both Spaces
- All Areas have 2 Handicapped Bathrooms
- 24' Clear Ceiling Height
- Building has 10 Bays
- All Bays are 30'x90' or 3,300 SF
- Building is Front-Loaded with Dock High Doors
- Bays 100 and 1,000 have Drive-in Doors

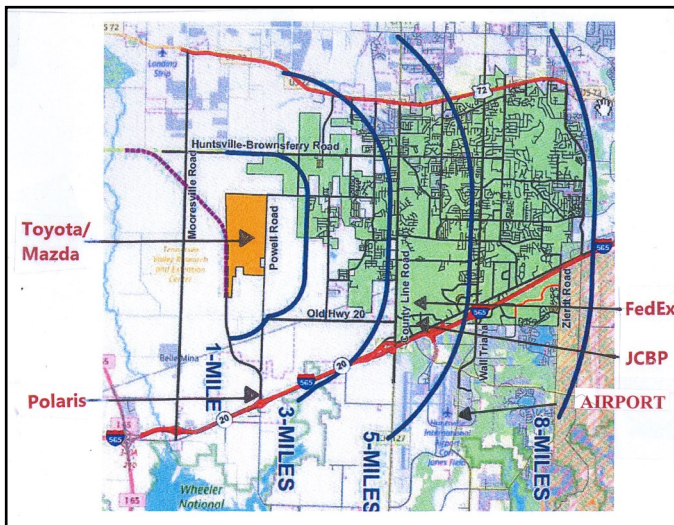

Located in the Center of  
Huntsville's Growth Corridor

MAL CLISSOLD  
Office: 615-370-1770  
Cell: 615-397-9506  
Email: mal@jcbp.com  
www.jcbp.com

#### Convenient Location Near:

- I-565
- I-65
- Huntsville International Airport
- FedEx Air and Ground
- Toyota/Mazda & Polaris



# Jetplex Circle Business Park

## 1021 PRODUCTION COURT

### Madison, AL 35758

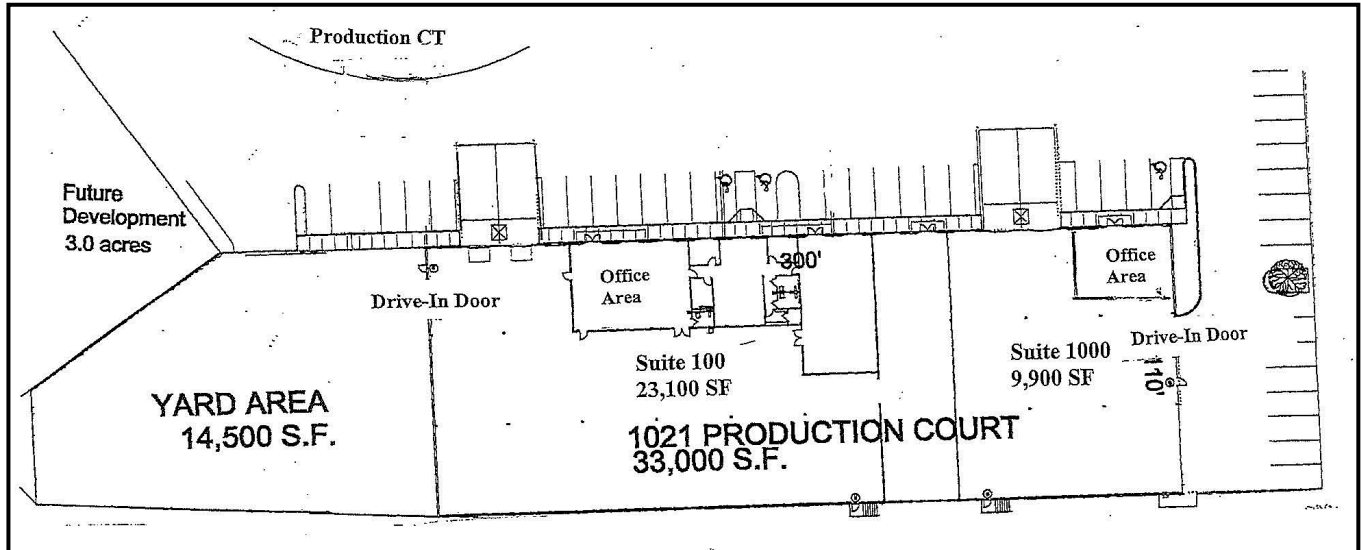

<b>Square Feet</b>				
<b>Suite</b>	<b>Total</b>	<b>Office</b>	<b>WH</b>	<b>% Office</b>
S 100	23,100	5,000	18,100	21.6%
S 1000	9,900	1,240	8,660	12.5%
<hr/>				
	33,000	6,140	26,860	18.6%

**Convenient Location Near:**

- I-565
- I-65
- Huntsville International Airport
- FedEx Air and Ground
- Toyota/Mazda & Polaris

MAL CLISSOLD  
 Office: 615-370-1770  
 Cell: 615-397-9506  
 Email: mal@jcbp.com  
 www.jcbp.com

